

FORM No. 1.

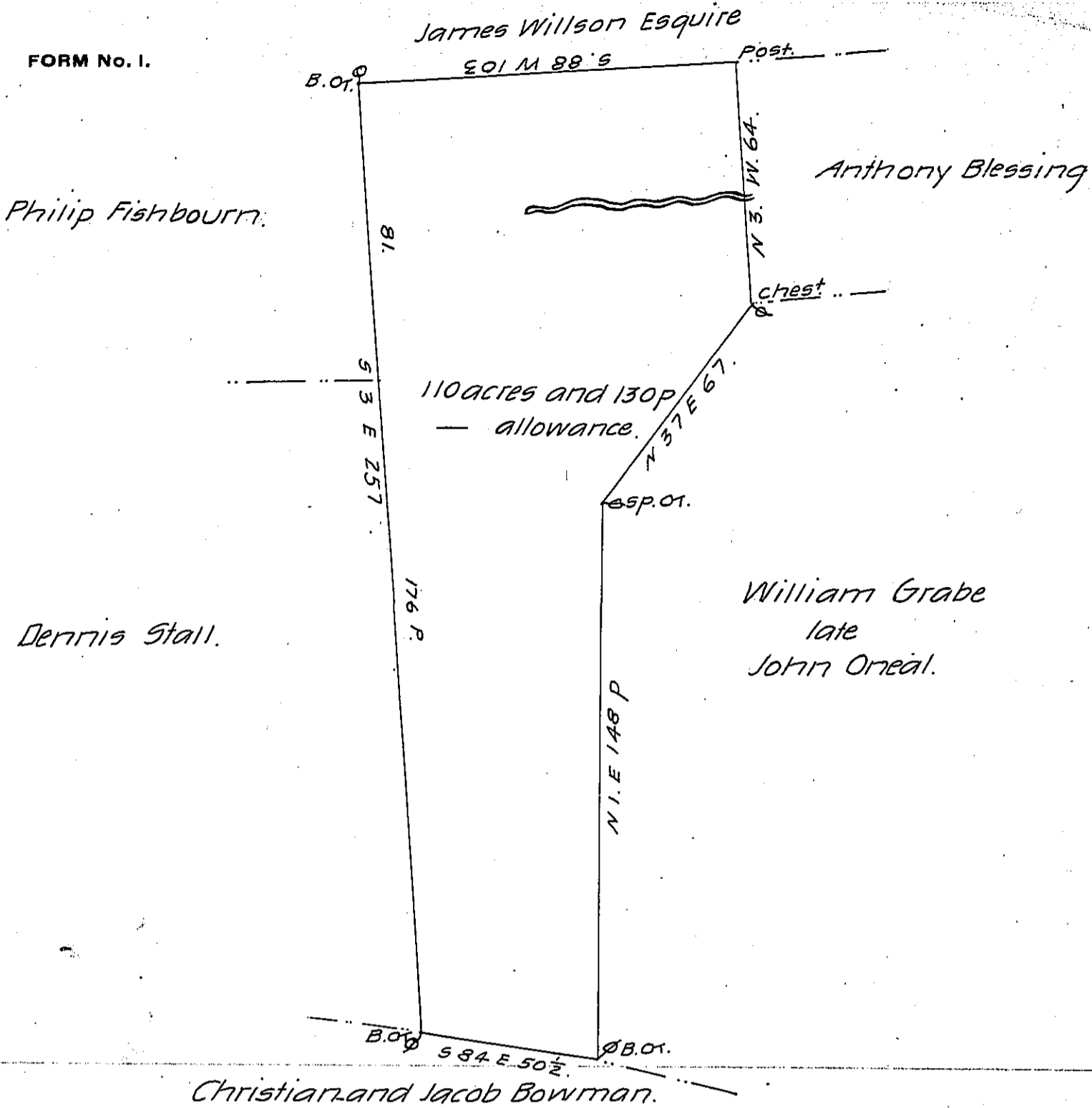

Surveyed the above described Tract of one hundred and Ten acres and 130 perches and allowance for Roads &c. Situate in Derry Township Dauphin County, (Part of Two hundred and forty eight acres and 110 perches and allowance,) Surveyed to John Orneal on his Warrant dated the 5th day of July 1750. Surveyed and divided of this 14th day of December 1802 for Michael Stuckrey.

Thomas Clark D.S.

Samuel Cochran Esquire
 Surveyor General-pennsylvania

IN TESTIMONY that the above is a copy of the original remaining on file in the Department of Internal Affairs of Pennsylvania, made conformably to an Act of Assembly approved the 16th day of February, 1833, I have hereunto set my Hand and caused the Seal of said Department to be affixed at Harrisburg, this fifteenth day of June 1906.

Isaac P. ...
 Secretary of Internal Affairs.